

# *Structures Laboratory*

*Civil & Environmental Engineering Department*

*University of New Orleans*

*Eng'r Bldg Rm 136*

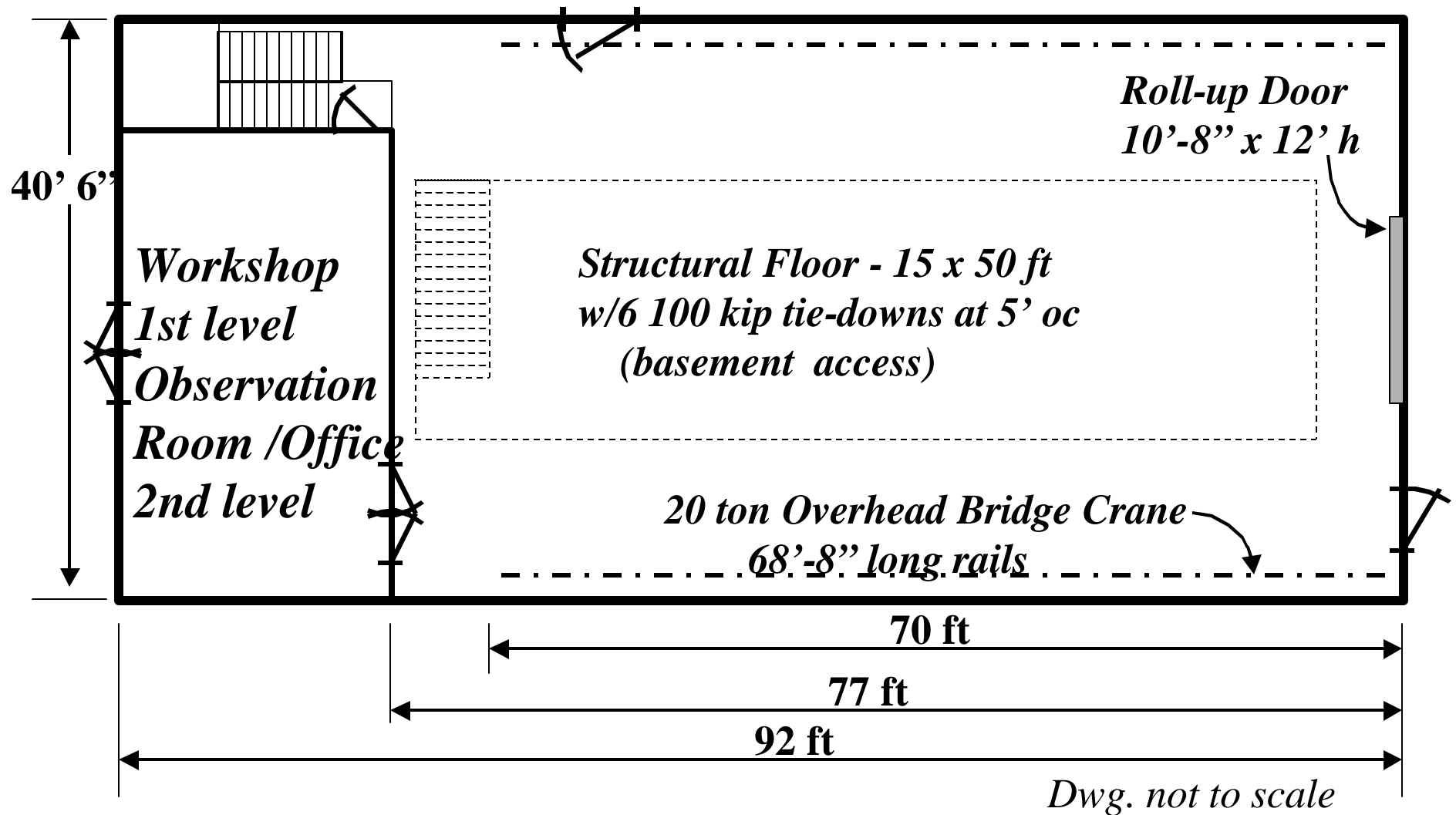

# Structures Laboratory

Civil & Environmental Engineering Department  
University of New Orleans  
Eng'r Bldg Rm 136

Multidirectional Load Frame  
21'-5" L x 10'-8" W  
x 10'-5" H  
w/6 computer controlled  
50 kip rams

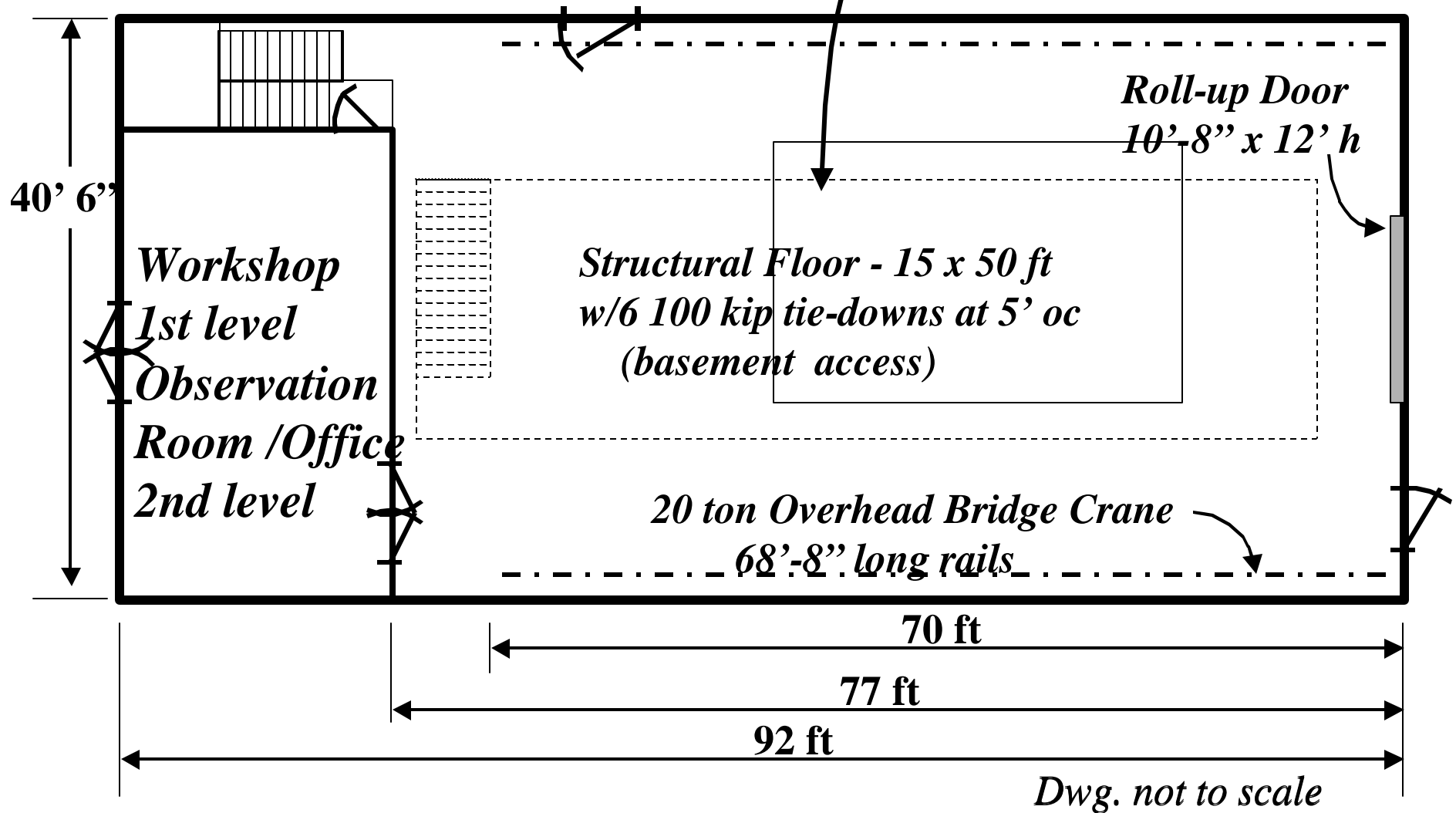

Dwg. not to scale

# Structures Laboratory

*UNO Civil Engineering  
Eng'r Bldg Rm 136*

## *Multidirectional Load Frame*

*21'-5''L x 10'-8''W x 10'-5''H*

*w/6 computer controlled 50 kip rams*

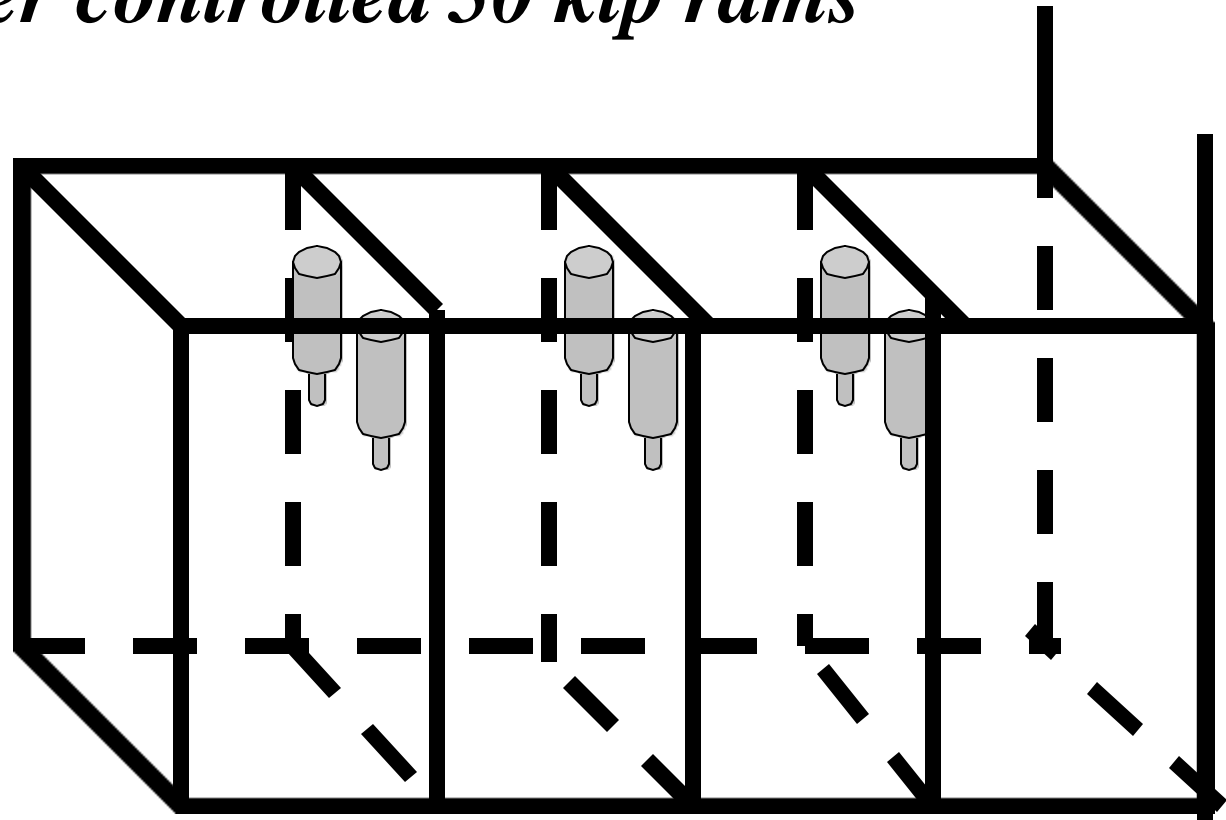

*Dwg. not to scale*